



## MS 400 Detector base



The detector head is installed in the detector base MS 400.

The base is suitable for surface-mounted cable feeds as well as for flush-mounted cable feeds, and has separate attachment points for ceiling mount/flush-mounted back boxes. In addition, it fits all standard bore patterns. The detector base made of white ABS plastic (Novodur, color similar to RAL 9010) has a matt finish and seven terminal screws to connect the detector and its features to the fire panel.

Contacts connected to the terminals guarantee a secure electric connection when the detector module is installed. Cables up to 2.5 mm<sup>2</sup> in diameter<sup>2</sup> can be used.

To protect against unauthorized removal, the detector head can be secured with a variable locking.

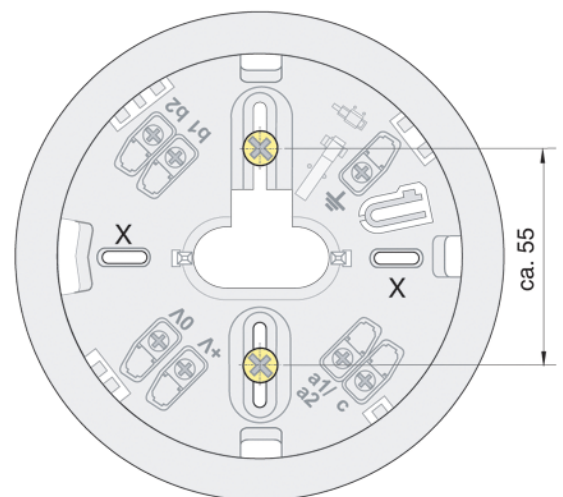
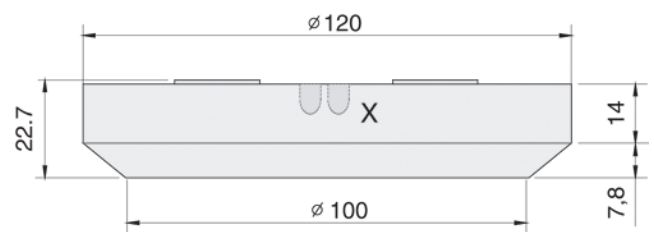

### Installation/Configuration Notes

#### Installation information for 400/420 series detector bases

- The drill holes marked with an "X" may only be used to mount the base to flush-mounted back boxes.
- Keep shielded auxiliary wire as short as possible, and make sure this is insulated.

## Technical Specifications

### MS 400 Detector base

Connections	Power supply (0 V, +V) LSN (a1/a2, b1, b2) C-point Shielding
Housing material	ABS (Novodur)
Housing color	Similar to RAL 9010
Dimensions	Ø 120 x 22.7 mm
Weight	72 g

## Ordering Information

MS 400 Detector base for surface-mounted and flush-mounted cable feed	MS 400
---	--------

**Americas:**  
Bosch Security Systems  
130 Perinton Parkway  
Fairport, New York, 14450, USA  
Phone: +1 585 223 4060  
Fax: +1 800 289 0096  
security.sales@us.bosch.com  
www.boschsecurity.us

**Europe, Middle East, Africa:**  
Bosch Security Systems B.V.  
P.O. Box 80002  
5600 JB Eindhoven, The Netherlands  
Phone: +31 (0) 40 27 83955  
Fax: +31 (0) 40 27 86668  
emea.securitysystems@bosch.com  
www.boschsecurity.com

**Asia-Pacific:**  
Bosch Security Systems Pte Ltd  
38C Jalan Pemimpin  
Singapore 577180  
Phone: +65 6319 3450  
Fax: +65 6319 3499  
apr.securitysystems@bosch.com  
www.boschsecurity.com

**Represented by**