



# DX4010i RS-232 Serial Interface Module



- ▶ Transparent enclosure
- ▶ Diagnostic light emitting diodes (LEDs)
- ▶ RJ-16 data bus connector
- ▶ DIP switches for address and bus programming
- ▶ Enhanced direct connection for Remote Programming Software (RPS)
- ▶ DB9 DTE RS-232 connector

The DX4010i RS-232 Serial Interface Module creates a local connection between compatible control panels and approved applications or other RS-232 devices. The module connects to the control panel's data bus which provides power and data.

## Functions

### DIP Switches

Use the external DIP switches to easily assign an address to the DX4010i RS-232 Serial Interface Module.

### RJ-16 Data Bus Connector and DB9 DTE RS-232 Connector

Use the RJ-16 data bus connector for a remote programming connection. Use the DB9 DTE RS-232 connector to connect to approved RS-232 devices.

### Transparent enclosure

The diagnostic LEDs show through the transparent enclosure, making troubleshooting easy and convenient.

### Diagnostic LEDs

There are four diagnostic LEDs that provide information about the transmission and receipt of data.

#### Two Red LEDs

BUS RX

BUS TX

#### Two Green LEDs

SER RX

SER TX

#### Function

Data bus receives data from control panel

Data bus transmits data to control panel

#### Function

RS-232 receives data from serial device

RS-232 transmits data to serial device

**System Overview**

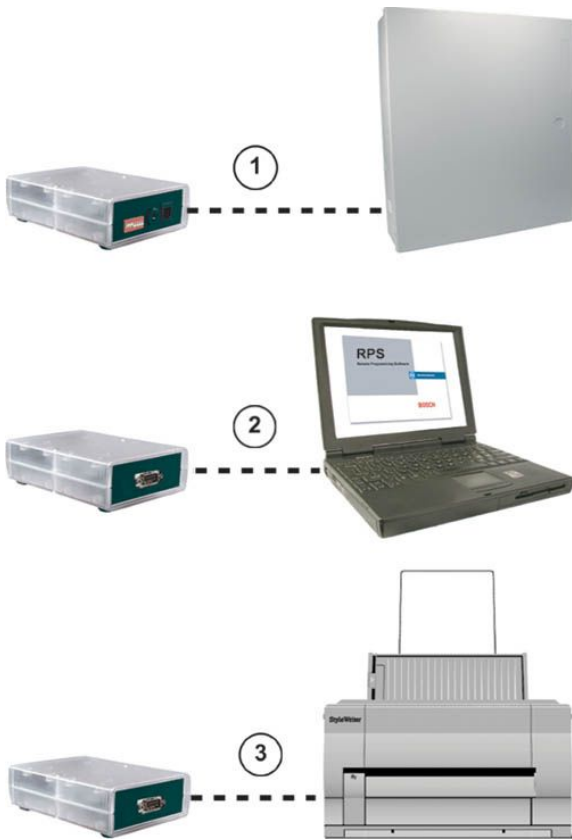

The DX4010i RS-232 Serial Interface Module connects to:

1. A control panel's option or serial device interface (SDI) bus through the data bus connector.
2. A PC for RPS, BIS, or other third party applications through the RS-232 connector.
3. A serial printer or parallel printer with a converter cable box (not shown) through the RS-232 connector with a compatible control panel. Refer to *Compatibility Information* for details.

**Installation/Configuration Notes**

**Compatibility Information**

**Applications and RS-232 Devices**

United States	RPS:	Supported on all compatible control panels.
	PC9000:	Supported on all the following control panels: D9412G, D7412G, D7212G, D9112, D7412, and D7212.
	Building Integration Software (BIS):	Supported on the following SDI bus control panels (version 6.3 and higher): D9412G, D7412G, and D7212G.
China	CMS 7000:	Supported on DS7400Xi Control Panels (option bus) set at Mode 18 (version 3.09 or higher).
All	Printers:	Supported on option bus control panels.

**SDI Bus Control Panels (version 6.0 or higher)**

- |               |  |
|---------------|--|
| United States | <ul style="list-style-type: none"> <li>• D7212G, D7412G, and D9412G</li> <li>• D7212, D7412, and D9412</li> <li>• D9112</li> </ul> |
|---------------|--|

**Option Bus Control Panels**

- |               |  |
|---------------|--|
| Europe        | <ul style="list-style-type: none"> <li>• DS7400Xi (version 2.02 or higher)</li> <li>• DS7220 and DS7240</li> </ul> |
| Australia     | <ul style="list-style-type: none"> <li>• CC7420-A</li> </ul>   |
| United States | <ul style="list-style-type: none"> <li>• D4412 and D6412</li> </ul>  |

The DX4010i RS-232 Serial Interface Module replaces the following modules:

United States	D9133 Serial Interface Module	For use with BIS, PC9000, or other third party applications on SDI bus control panels.
	D9133DC Serial Interface Module	For use with RPS or other third party applications on SDI bus control panels.
	D9533 RS-232 Serial Interface Module	For use with RPS, CMS 7000*, or printers on option bus control panels
Europe, United States, and China	DX4010 RS-232 Serial Interface Module	For use with RPS, CMS 7000*, or printers on option bus control panels.

\*CMS 7000 is available in China only.

## Technical Specifications

### Environmental Considerations

Operating Temperature:	0°C to +50°C (+32°F to +122°F)
Relative Humidity:	5% to 85% at +30°C (+86°F) non-condensing

### Power Requirements

Current (Maximum):	50 mA nominal, 55 mA with LED
Voltage (Operating):	8 VDC to 14 VDC

## Ordering Information

DX4010i RS-232 Serial Interface Module      DX4010i  
 Locally connects compatible control panels and  
 approved applications or other RS-232 devices.

**Americas:**  
 Bosch Security Systems  
 130 Perinton Parkway  
 Fairport, New York, 14450, USA  
 Phone: +1 585 223 4060  
 Fax: +1 800 289 0096  
 security.sales@us.bosch.com  
 www.boschsecurity.us

**Europe, Middle East, Africa:**  
 Bosch Security Systems B.V.  
 P.O. Box 80002  
 5600 JB Eindhoven, The Netherlands  
 Phone: +31 40 27 83955  
 Fax: +31 40 27 86668  
 emea.securitysystems@bosch.com  
 www.boschsecurity.com

**Asia-Pacific:**  
 Bosch Security Systems Pte Ltd  
 38C Jalan Pemimpin  
 Singapore 577180  
 Phone: +65 6319 3450  
 Fax: +65 6319 3499  
 apr.securitysystems@bosch.com  
 www.boschsecurity.com

**Represented by**